

0F3SR230B140000

SLIPPER CLUTCH KIT FOR CBR-600 RR

ASSEMBLING DIRECTIONS

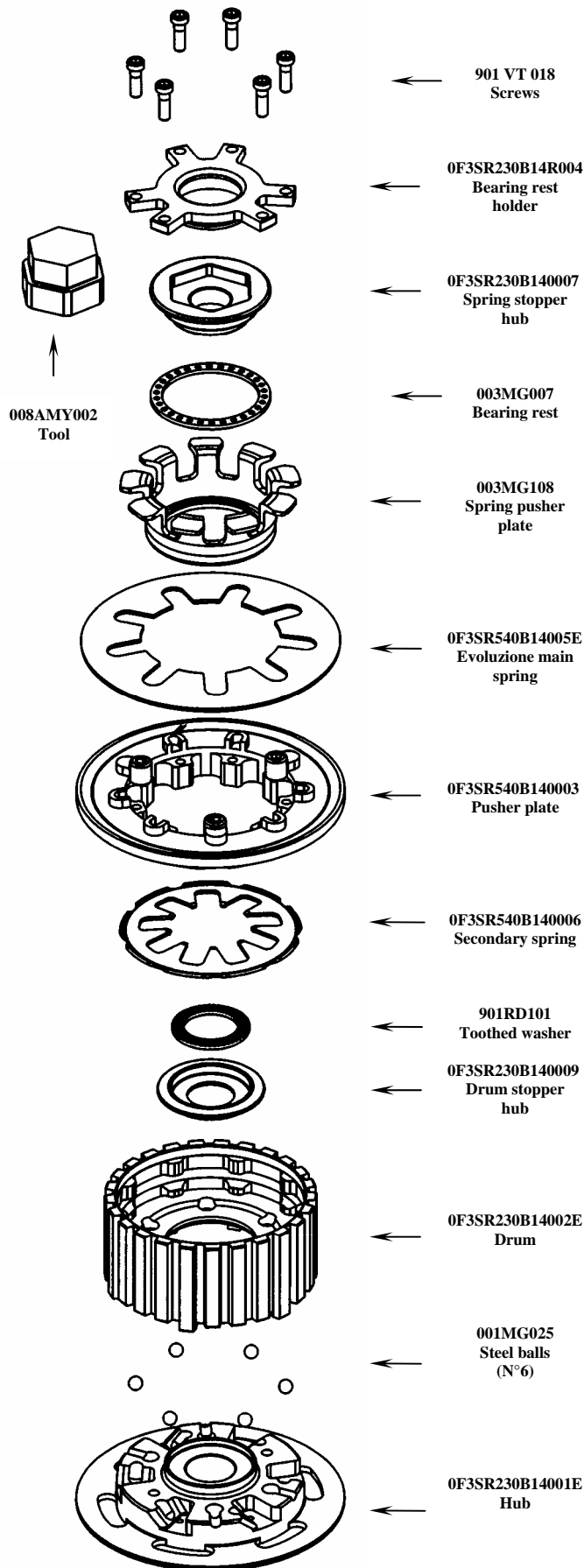

Perform the assembly starting from the hub pack: put the hub (0F3SR230B14001E), put the 6 steel balls (001MG025), at the bottom of grooves using a little bit of grease.

Fix the drum (0F3SR230B14002E), on hub on rest position.

-Insert the hub pack on main shaft

-Insert the drum stopper hub (0F3SR230B140009) on its seat, into the hub (0F3SR230B14001E).

-Insert the secondary spring (0F3SR540B140006) into the drum on its seat.

-Reinstall original plates, according to the manufacturer's directions. Total thickness has to be 42.1mm.

Unscrew the 6 screws (901VT018), paying attention not to lose the six toothed washers (901RD007), and take the bearing rest holder (0F3SR230B14R004) off.

Insert the M22 toothed washer (901RD101) into the seat of the upper part of the drum stopper hub (0F3SR230B14009) with the dished part facing up.

Insert the pusher plate (0F3SR540B 140003) into the drum seats (0F3SR23B14002E).

Insert the main Evoluzione spring (0F3SR540B14005E) into the pusher plate (0F3SR23B14002E).

Pre- assemble the spring stopper kit :

insert into the spring pusher plate, (003MG108), the bearing rest (003MG007) and the hub spring stopper (0F3SR230B140007);

Insert the spring stopper kit into the Evoluzione main spring (0F3SR540B14005E) previously assembled on pusher plate (0F3SR540B140003) screwing the spring stopper hub on main shaft, using STM tool (008AMY002) included into the package, lock with the dynamometric key to the torque suggested by the manufacturer.

Use STM tool (002AMS001) to hold pusher plate while tightening.

Pre-assemble the bearing rest holder kit:

assemble the bearing rest and the toothed pull pin (of the original clutch) inserting all in the seat of the bearing rest (0F3SR230B14R004).

-Put the bearing rest (0F3SR230B14R004) into pusher plate seat (0F3SR540B140003), paying attention to insert it correctly into grooves and fix with the six screws (901VT018).

NB: once completed the assembly pull and release the clutch lever checking that pusher plate performs opening and closing movements correctly.

GENERAL SAFETY REGULATIONS

- In this sheet are reported the directions to perform correctly the clutch assembly operations.
- STM reserves the right - without notice - to introduce any technical change whenever deemed it to be necessary to improve functionality and quality of the products.
- Assembly operations must be performed by a skilled technician and must be scrupulously observed.
- Before mounting the clutch make a complete inspection of the various parts, in order to verify the possible presence of faults or anomalies on the motorbike.
- Make sure that there are no missing/damaged parts in the package .
- Some parts of the clutch and its components can have sharp surface: handle with care.
- Some components of the clutch, because of their small dimensions can be swallowed: keep away from children.



STRADA srl

Strada Fontaneto Regione Gionchetto – 10023 Chieri (TO)

Tel +39 011 9422832 Fax +39 011 9471447

Internet :www. stm . to . it E-mail : strada @ stm .to. it